

V-TRAK

USER GUIDE

CMA | LOCKING SCREWS CHECKLIST

CMA 100-250 | Central mounting assembly

- 1 Arm Screws x 2 Top & Bottom
- 2 Locking Lever x 2
- 3 Locking Lever secure nut x 2
- 4 CMA - Pivot Screws x 2 opposite thread
- 5 Height setting screws x 2
- 6 CMA Locking screws x 2 contact with arms
- 7 CMA Locking cams x 2 Top & Bottom
- 8 CMA - Integral pivot lock

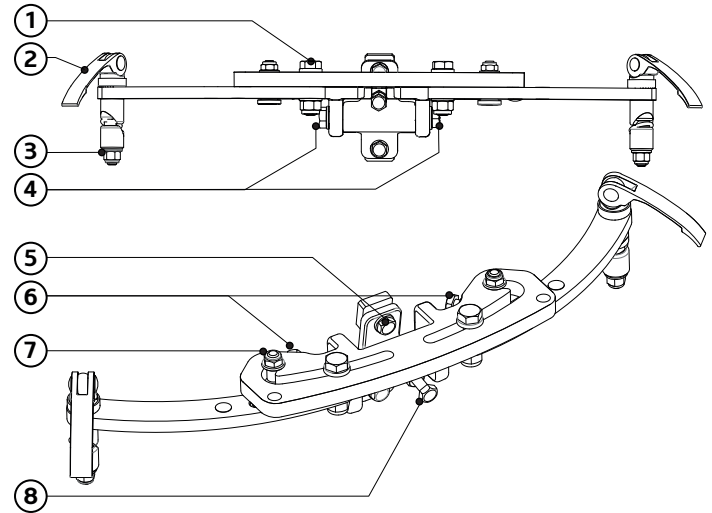

! PLEASE TIGHTEN & CHECK ALL SCREWS FOR SAFETY AND SECURITY
ONCE SCREWS ARE TIGHTENED AND LOCKED THE COVER CAN BE ATTACHED

Document Number: IFU CMA/HWC V1.0

These instructions are intended to be a pictorial guide only and should not be used as a substitute for professional judgement. If there are any queries or any uncertainties please call us (01443 236 530) or email us info@v-trak.com for technical support



V-TRAK

USER GUIDE

CMA | LOCKING SCREWS CHECKLIST

CMA 100-250 | Central mounting assembly

- 1 Arm Screws x 2 Top & Bottom
- 2 Locking Lever x 2
- 3 Locking Lever secure nut x 2
- 4 CMA - Pivot Screws x 2 opposite thread
- 5 Height setting screws x 2
- 6 CMA Locking screws x 2 contact with arms
- 7 CMA Locking cams x 2 Top & Bottom
- 8 CMA - Integral pivot lock

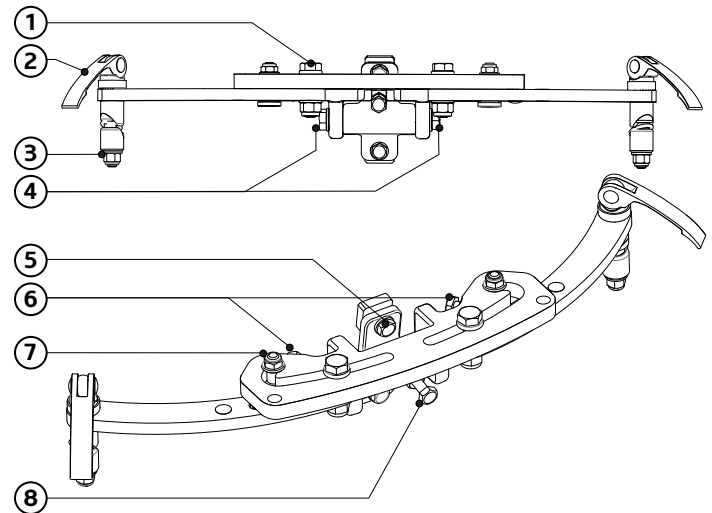

! PLEASE TIGHTEN & CHECK ALL SCREWS FOR SAFETY AND SECURITY
ONCE SCREWS ARE TIGHTENED AND LOCKED THE COVER CAN BE ATTACHED

Document Number: IFU CMA/HWC V1.0

These instructions are intended to be a pictorial guide only and should not be used as a substitute for professional judgement. If there are any queries or any uncertainties please call us (01443 236 530) or email us info@v-trak.com for technical support



V-TRAK

USER GUIDE

CMA | LOCKING SCREWS CHECKLIST

CMA 100-250 | Central mounting assembly

- 1 Arm Screws x 2 Top & Bottom
- 2 Locking Lever x 2
- 3 Locking Lever secure nut x 2
- 4 CMA - Pivot Screws x 2 opposite thread
- 5 Height setting screws x 2
- 6 CMA Locking screws x 2 contact with arms
- 7 CMA Locking cams x 2 Top & Bottom
- 8 CMA - Integral pivot lock

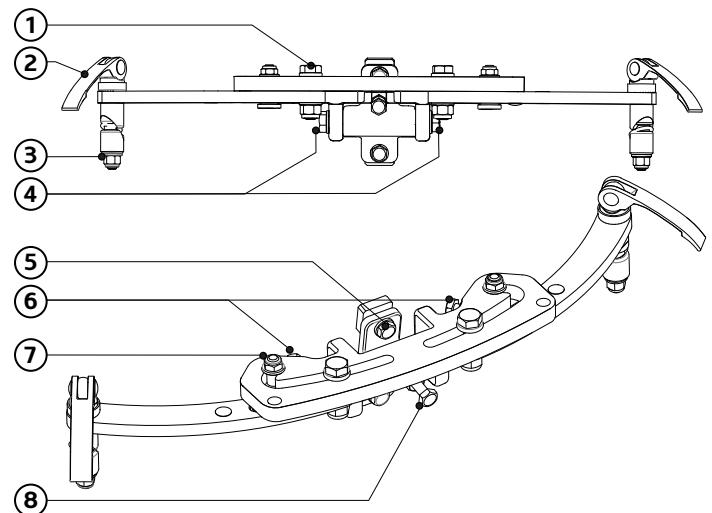

! PLEASE TIGHTEN & CHECK ALL SCREWS FOR SAFETY AND SECURITY
ONCE SCREWS ARE TIGHTENED AND LOCKED THE COVER CAN BE ATTACHED

Document Number: IFU CMA/HWC V1.0

These instructions are intended to be a pictorial guide only and should not be used as a substitute for professional judgement. If there are any queries or any uncertainties please call us (01443 236 530) or email us info@v-trak.com for technical support



HWC | V-TRAK HARDWARE COVER

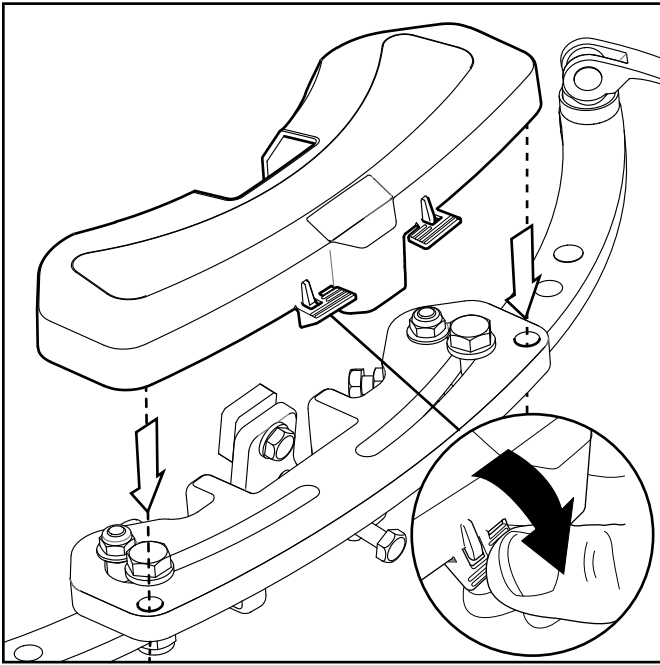

HWC | V-TRAK HARDWARE COVER

ONLY ATTACH COVER ONCE THE HARDWARE HAS BEEN ADJUSTED AND TIGHTENED

Cover locates in CMA holes indicated. Please make sure any caps are removed.

Once in position, push clips down and you will hear an audible click. This will secure cover in place.

CMA | PIVOT LOCKS

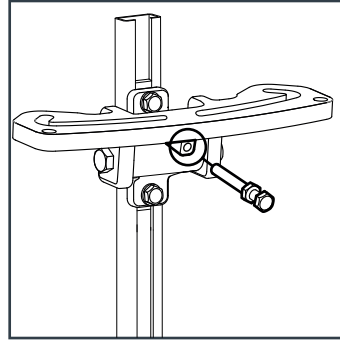

Integral pivot lock - Screw bears against Centre boss

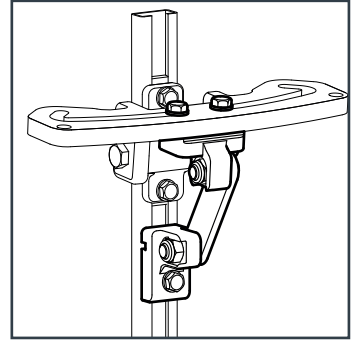

Additional Pivot lock on V-Trak

HWC | V-TRAK HARDWARE COVER

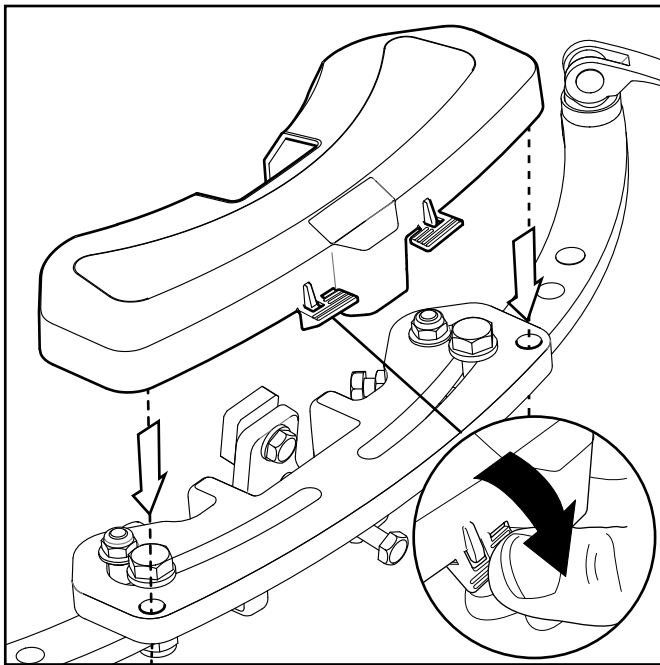

HWC | V-TRAK HARDWARE COVER

ONLY ATTACH COVER ONCE THE HARDWARE HAS BEEN ADJUSTED AND TIGHTENED

Cover locates in CMA holes indicated. Please make sure any caps are removed.

Once in position, push clips down and you will hear an audible click. This will secure cover in place.

CMA | PIVOT LOCKS

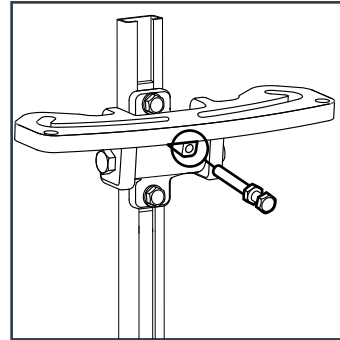

Integral pivot lock - Screw bears against Centre boss

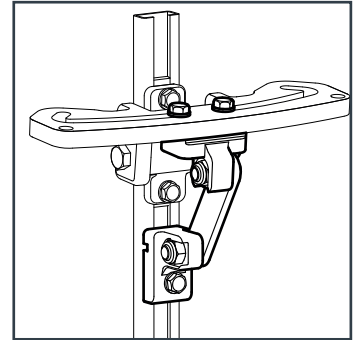

Additional Pivot lock on V-Trak

HWC | V-TRAK HARDWARE COVER

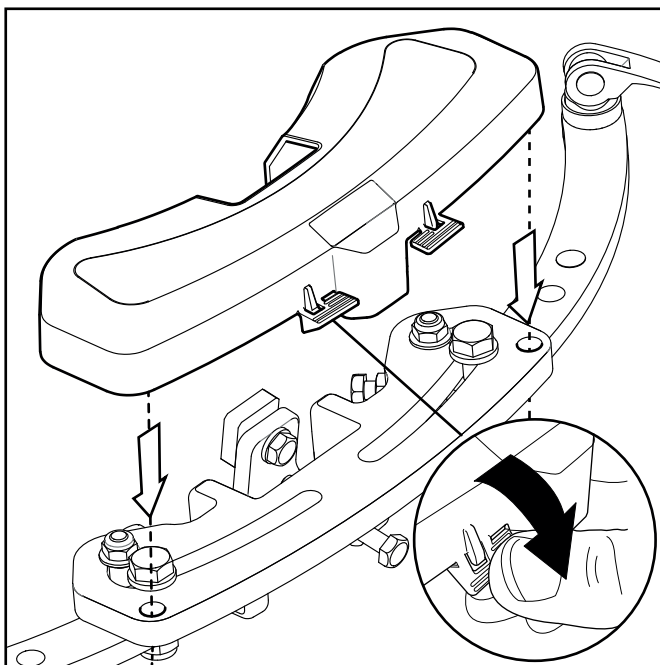

HWC | V-TRAK HARDWARE COVER

ONLY ATTACH COVER ONCE THE HARDWARE HAS BEEN ADJUSTED AND TIGHTENED

Cover locates in CMA holes indicated. Please make sure any caps are removed.

Once in position, push clips down and you will hear an audible click. This will secure cover in place.

CMA | PIVOT LOCKS

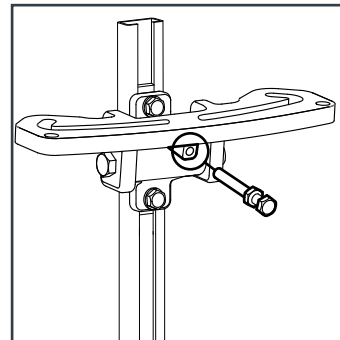

Integral pivot lock - Screw bears against Centre boss

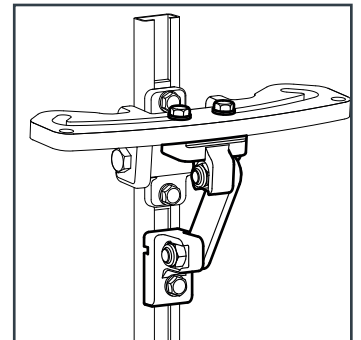

Additional Pivot lock on V-Trak